

Vacuum meter VT-RC01



The thermoresistive digital vacuum gauge VT-RC01 is designed to convert the absolute pressure in the range $1 \cdot 10^{-2} - 1 \cdot 10^{-5}$ Pa into an electrical digital signal.

It is used in automated vacuum systems for industrial, experimental and educational purposes. Contains built-in sensor DTV-01 (thermoelectric, Pirani type), version KF16 / KF 25

Parameter

Value

- Working pressure range $1 \cdot 10^{-2}$ Pa ... $1 \cdot 10^{-5}$ Pa
- Pressure measurement range $1 \cdot 10^{-1}$ Pa ... $1 \cdot 10^{-3}$ Pa
- Power consumption, no more than 6.0 W
- Nominal supply voltage 24 V ($\pm 10\%$)
- Weight no more than 0.25 kg
- External connections RS-485 / Modbus RTU
- Limits of relative measurement error ($\delta, \%$) in the range $1 \cdot 10^{-1}$... $1 \cdot 10^{-3}$ Pa $\pm 30\%$, the rest of the range is not standardized

Included in the register of measuring instruments. Registration number 81993-21. 

Interlocking thermoresistive vacuum meter VTR-RC01

Vacuum meter VT-RC01

basic dimensions, completeness

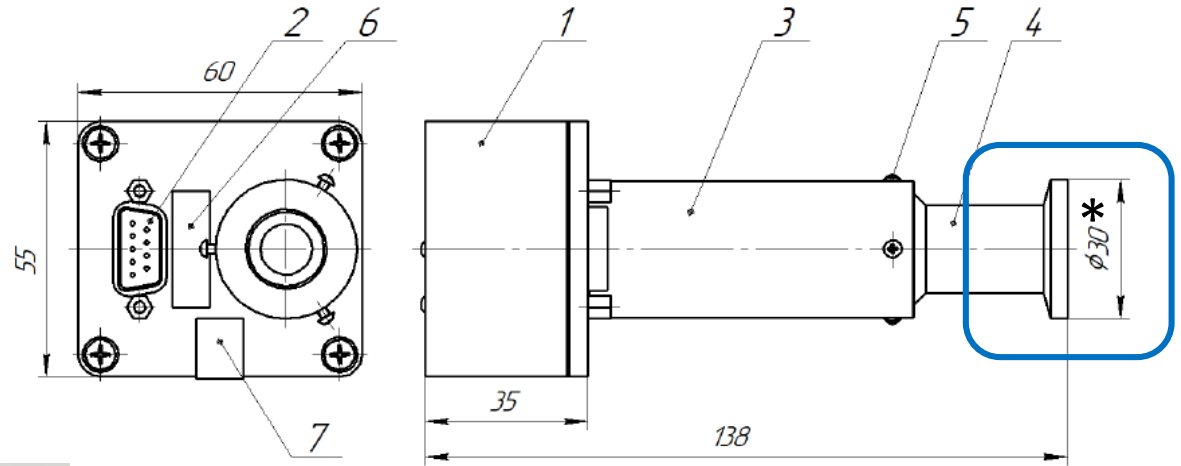

- 1 - device case with electronics unit
 - 2 - DB-9M plug
 - 3 - converter housing
 - 4 - converter
 - 5 - screw for fastening the converter (M2)
 - 6 - the place of the serial number marking
 - 7 - the place of application of the seal-sticker
- *) In the drawing dimension $\phi 30$ mm - for KF16, for KF 25 $\phi 40$ mm
DTV sensor - can be supplied separately

When ordering: Specify standard size connector **KF 16 / KF 25**